

5/29/2026 9:21:57 AM

1 FIRST FLOOR LIFE SAFETY PLAN  
1/16" = 1'-0"

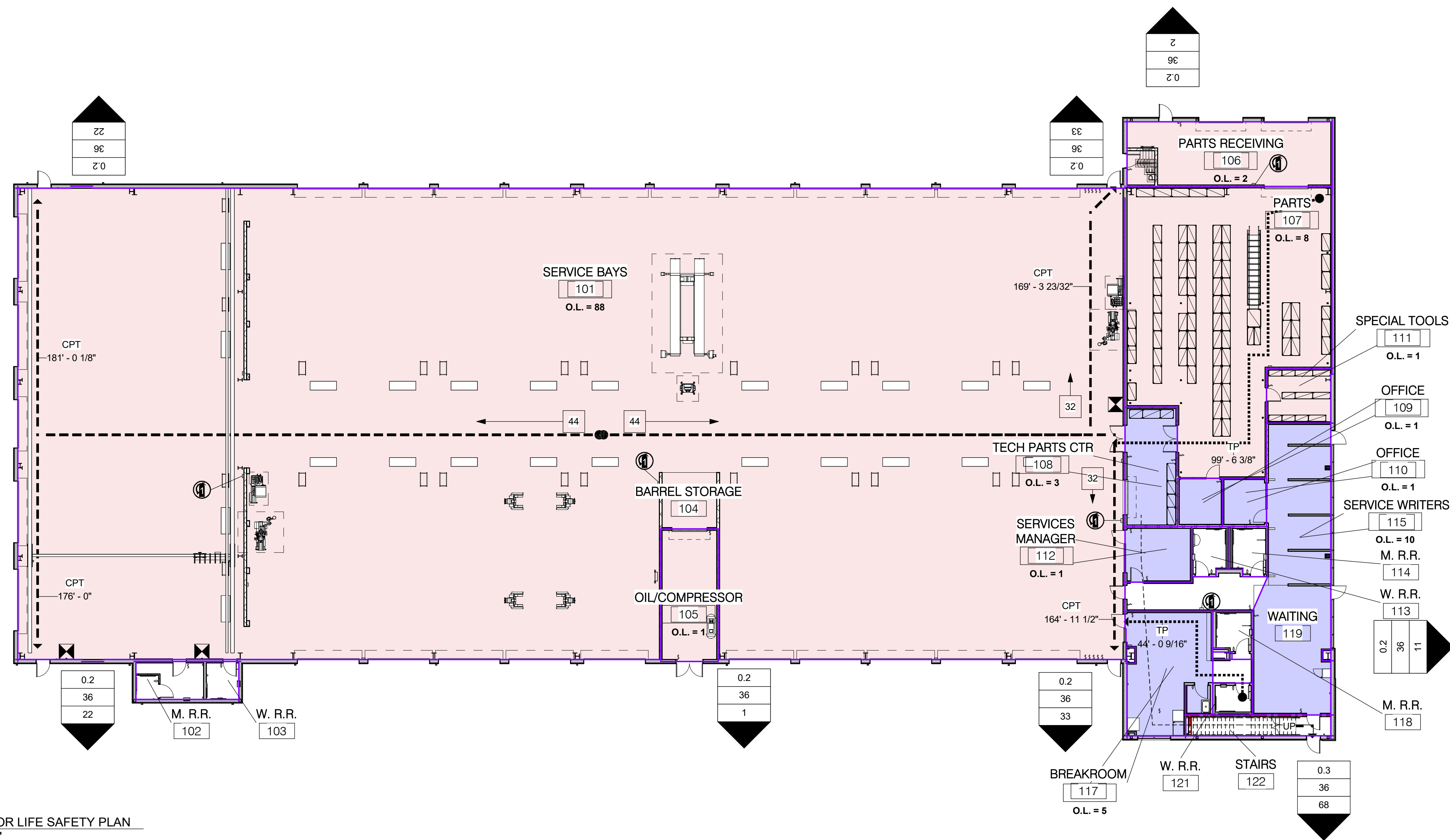

OCCUPANT LOAD PER IBC TABLE 1004.1.2

BUSINESS 100 S.F. / PERSON	OCCUPANT LOAD = 21
S-1 STORAGE 300 S.F. / PERSON	OCCUPANT LOAD = 94

OCCUPANT LOAD PER IBC TABLE 1004.1.2

BUSINESS 100 S.F. / PERSON	OCCUPANT LOAD = 2
ASSEMBLY 15 S.F. / PERSON	OCCUPANT LOAD = 58
S-1 STORAGE 300 S.F. / PERSON	OCCUPANT LOAD = 8

TOTAL OCCUPANT LOAD = 174

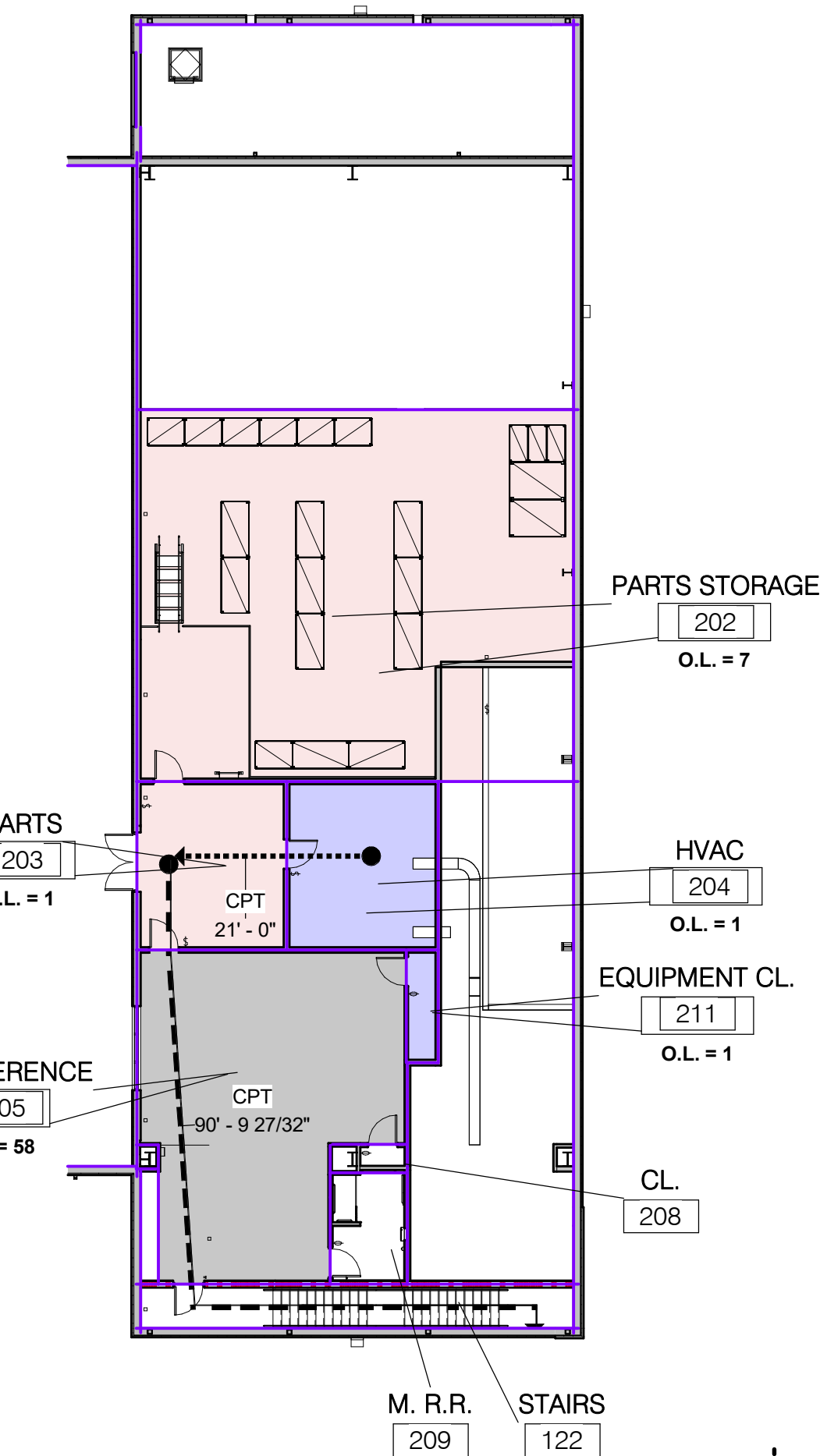

2 2ND FLOOR  
1/16" = 1'-0"

EGRESS LEGEND

	FIRE EXTINGUISHER AND RECESSED CABINET (MAX 75' - 0" TRAVEL DISTANCE FROM EACH LOCATION)
	OCCUPANT LOAD FACTOR (INCHES/OCCUPANTS)
	EXIT WIDTH PROVIDED (IN INCHES)
	NUMBER OF OCCUPANTS
	DIVIDED ROOM OCCUPANCY
	TRAVEL DISTANCE = TD
	COMMON PATH OF TRAVEL = CPT

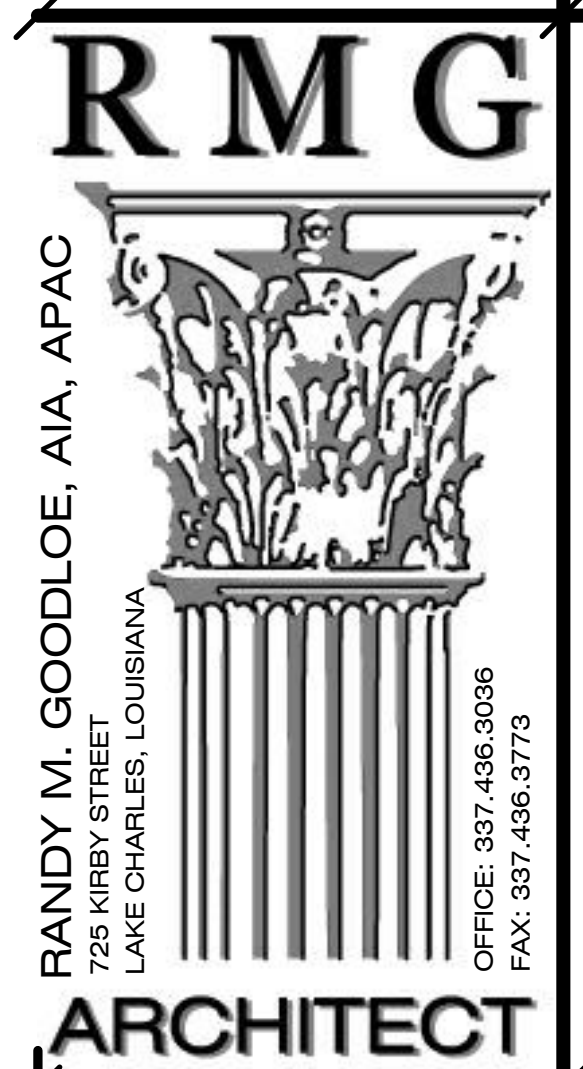

LA. LICENSE NO. 4086

NEW CONSTRUCTION  
FORD PRO  
FOR  
MIKE WILLIS  
2010 PATTON ST.

COPYRIGHT 2026,  
RANDY M. GOODLOE, AIA, APAC  
ALL INFORMATION, EITHER DRAWN, WRITTEN,  
OR IMPLIED APPEARING IN THIS DOCUMENT  
SHALL NOT BE DUPLICATED, DISCLOSED, OR  
OTHERWISE USED WITHOUT THE WRITTEN  
PERMISSION OF THE AUTHOR, RANDY M.  
GOODLOE, AIA, APAC. THIS DOCUMENT IS AN  
INSTRUMENT OF SERVICE AND IS THE SOLE  
PROPERTY OF THE AUTHOR. FURTHERMORE,  
THE USE OF THIS DOCUMENT FOR ANY  
PURPOSE SHALL BE REVOKED, IF THE INTENT  
OF THE DESIGN OR THE CONSTRUCTION  
TECHNIQUES OR DETAILS SHOWN HEREIN  
ARE NOT ADHERED TO OR THE  
CONTRACTUAL AGREEMENT GOVERNING  
THEIR USE ARE NOT STRICTLY ADHERED TO.

PROJECT NO.  
25012  
PROJECT MANAGER  
TM  
DATE ISSUED  
2026.05.22  
REVISED

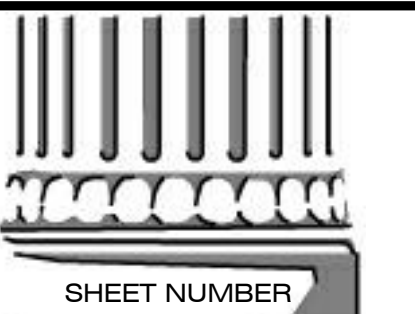
SHEET NUMBER  
A-006  
LIFE SAFETY PLAN